



Nightingale Avenue

Darlington DL1 2AY

Offers Over £125,000





This footer paragraph is an example only and should not be relied upon as complying with current legislation. These particulars, whilst believed to be accurate are set out as a general outline only for guidance and do not constitute any part of an offer or contract. Intending purchasers should not rely on them as statements of representation of fact, but must satisfy themselves by inspection or otherwise as to their accuracy. No person in this firms employment has the authority to make or give any representation or warranty in respect of the property.

Nightingale Avenue

Darlington DL1 2AY



- Semi Detached
- Gardens & Off Street Parking

- Three Bedrooms
- Council Tax Band A

- Ideal Family Home
- EPC Rating C

A spacious well presented three bedroom semi detached property located in the popular Haughton area of Darlington.

The property benefits from lounge, spacious kitchen, three good size bedrooms, front and rear gardens, off street parking, gas central heating and double glazing. The property would suit the needs of a variety of purchasers. It is situated close to the Education Village, bus routes in and out of town and local amenities.

Entrance Hall

Upvc door to the front, radiator, storage cupboard and staircase to the first floor.

Lounge

14'1 x 13'1 (4.29m x 3.99m)

Upvc double glazed window to the front, radiator and gas fire.

Kitchen

22'1 x 8'6 (6.73m x 2.59m)

Two upvc double glazed windows to the rear, fitted with a range of wall, base and drawer units, contrasting work surfaces, space for cooker, stainless steel sink unit, space for washer, space for fridge and upvc door to the side.

First Floor

Landing. With upvc double glazed window to the side.

Bedroom 1

12'9 x 11'5 (3.89m x 3.48m)

Upvc double glazed window to the front, fitted wardrobes, sink unit and radiator.

Bedroom 2

12'5 x 8'6 (3.78m x 2.59m)

Upvc double glazed window to the rear, radiator and storage cupboard.

Bedroom 3

9'6 x 7'5 (2.90m x 2.26m)

Upvc double glazed window to the front and radiator.

Bathroom

Fitted with a suite comprising bath with shower over, low level wc, wash hand basin, heated towel rail and upvc double glazed window to the rear.

Externally

To the front of the property the garden is laid to lawn and has off street parking. There is a large garden to the rear laid to lawn with patio area.

Council Tax

Band A

Tenure

This property is freehold

Note

IMPORTANT NOTE TO PURCHASERS: We endeavour to make our sales particulars accurate and reliable, however, they do not constitute or form part of an offer or any contract and none is to be relied upon as statements of representation or fact. The services, systems and appliances listed in this specification have not been tested by us and no guarantee as to their operating ability or efficiency is given. All measurements have been taken as a guide to prospective buyers only, and are not precise. Floor plans where included are not to scale and accuracy is not guaranteed. If you require clarification or further information on any points, please contact us, especially if you are travelling some distance to view. Fixtures and fittings other than those mentioned are to be agreed with the seller. We cannot also confirm at this stage of marketing the tenure of this house

GROUND FLOOR

1ST FLOOR

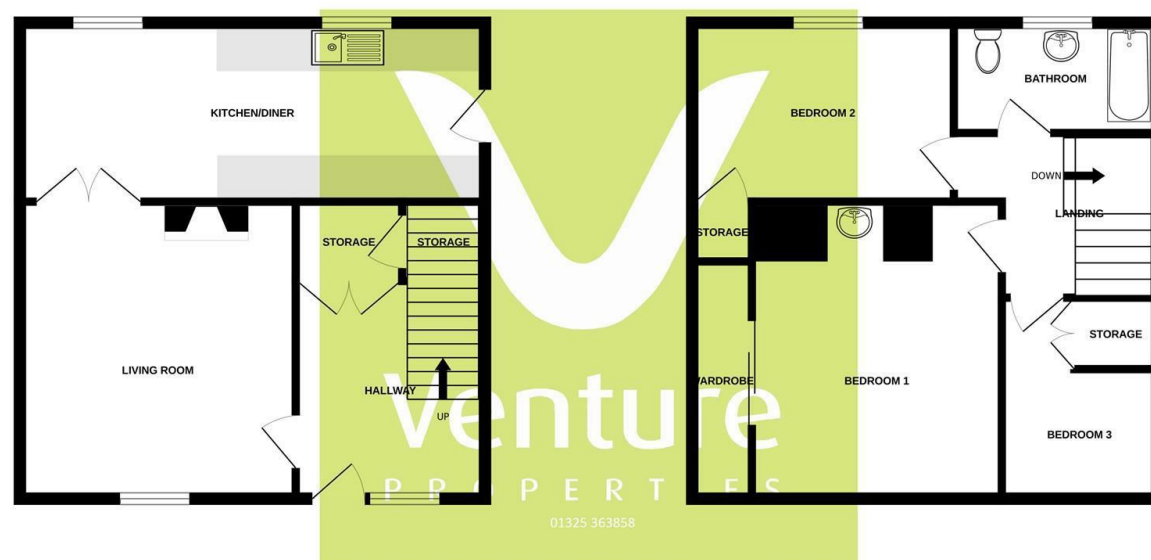

Whilst every attempt has been made to ensure the accuracy of the floorplan contained here, measurements of doors, windows, rooms and any other items are approximate and no responsibility is taken for any error, omission or mis-statement. This plan is for illustrative purposes only and should be used as such by any prospective purchaser. The services, systems and appliances shown have not been tested and no guarantee as to their operability or efficiency can be given.
Made with Metropix ©2023

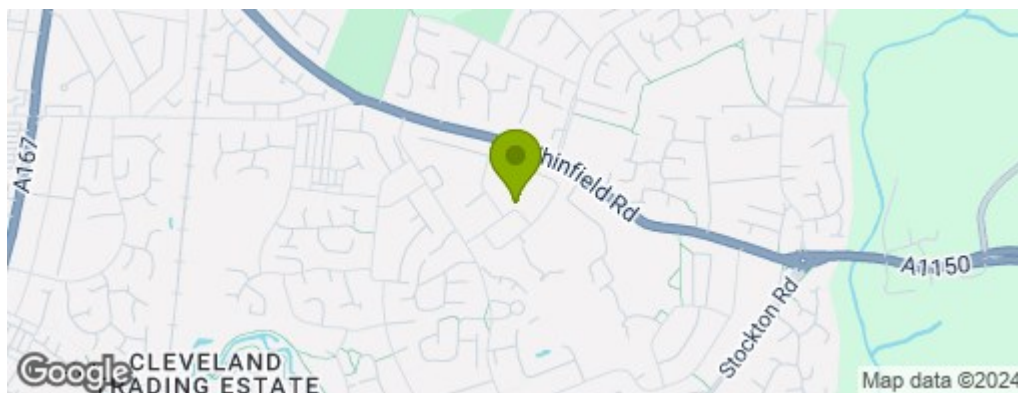

Property Information

01325 363858

45 Duke Street, Darlington, County Durham, DL3 7SD
sales@venturepropertiesuk.com